

# RIVERSIDE CROSSING PAD

SEC RIVER RD & LA CHOLLA BLVD, TUCSON, AZ



For Sale | SP Zoned PAD

WE ARE  
THE CENTER  
OF RETAIL



Dave Hammack / dhammack@picor.com / +1 520 546 2712  
Tom Nieman / tnieman@picor.com / +1 520 546 2728  
PICOR.COM



CUSHMAN &  
WAKEFIELD



PICOR

# RIVERSIDE CROSSING PAD

SEC RIVER RD & LA CHOLLA BLVD, TUCSON, AZ

## PAD SIZE

1.236 Acres (±53,844 SF)\*

\*Per Pima County Assessor

## SALE PRICE

\$625,000

## NEIGHBORING TENANTS

Bashas', Candlewood Suites, AFNI, National Bank of Arizona  
Panda Express, Viva Burrito & More

## COMMENTS

- One mile south of Northwest Hospital campus
- Located on a major East-West thoroughfare with convenient access to I-10
- Surrounded by densely populated residential communities.

## TRAFFIC COUNTS

River Rd: 27,924 vpd (2017)

La Cholla Blvd: 32,507 vpd (2017)

## ZONING

SP, Pima County (commercial land uses, including office and medical facilities)

## NEIGHBORHOOD DEMOGRAPHICS



POPULATION



AVERAGE  
HOUSEHOLD INCOME



DAYTIME  
POPULATION



TOTAL RETAIL  
EXPENDITURE

	POPULATION	AVERAGE HOUSEHOLD INCOME	DAYTIME POPULATION	TOTAL RETAIL EXPENDITURE
1 Mile	10,801	\$62,837	7,646	\$113.9 M
3 Miles	71,592	\$57,260	43,492	\$746.2 M
5 Miles	179,214	\$67,157	87,978	\$2.01 B



**Dave Hammack** / Principal, Retail Properties / dhammack@picor.com / +1 520 546 2712

**Tom Nieman** / Principal, Office Properties / tnieman@picor.com / + 1 520 546 2728

*Independently Owned and Operated / A Member of the Cushman & Wakefield Alliance*  
4/16/2019  
Cushman & Wakefield Copyright 2019. No warranty or representation, express or implied, is made to the accuracy or completeness of the information contained herein, and same is submitted subject to errors, omissions, change of price, rental or other conditions, withdrawal without notice, and to any special listing conditions imposed by the property owner(s). As applicable, we make no representation as to the condition of the property (or properties) in question.





CUSHMAN &  
WAKEFIELD



PICOR

# RIVERSIDE CROSSING PAD

SEC RIVER RD & LA CHOLLA BLVD, TUCSON, AZ

## CONCEPTUAL PLAN FOR RETAIL

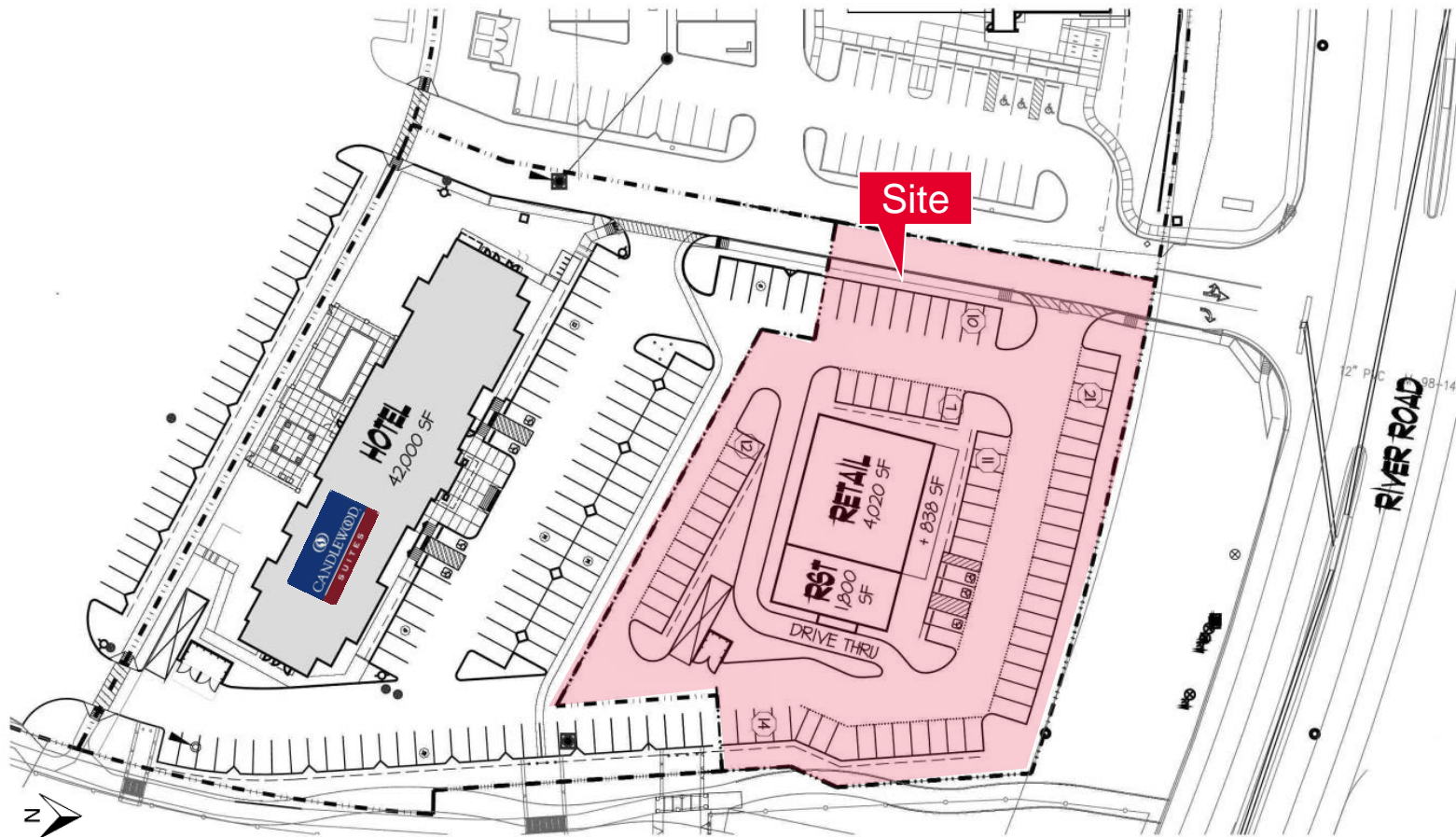

**Dave Hammack** / Principal, Retail Properties / dhammack@picor.com / +1 520 546 2712  
**Tom Nieman** / Principal, Office Properties / tnieman@picor.com / + 1 520 546 2728

Independently Owned and Operated / A Member of the Cushman & Wakefield Alliance 4/16/2019  
Cushman & Wakefield Copyright 2019. No warranty or representation, express or implied, is made to the accuracy or completeness of the information contained herein, and same is submitted subject to errors, omissions, change of price, rental or other conditions, withdrawal without notice, and to any special listing conditions imposed by the property owner(s). As applicable, we make no representation as to the condition of the property (or properties) in question.



CUSHMAN &  
WAKEFIELD



PICOR

# RIVERSIDE CROSSING PAD

SEC RIVER RD & LA CHOLLA BLVD, TUCSON, AZ

## CONCEPTUAL PLAN FOR MEDICAL/OFFICE BUILDING

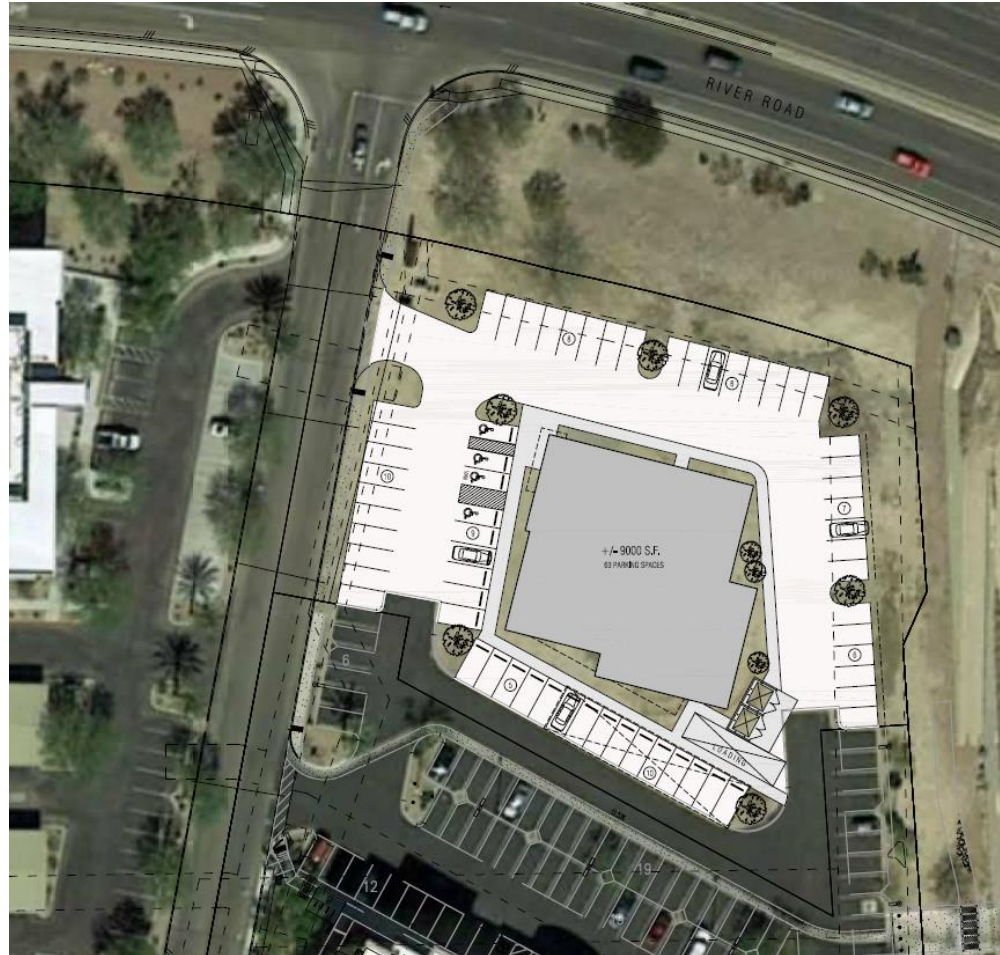

**Dave Hammack** / Principal, Retail Properties / dhammack@picor.com / +1 520 546 2712  
**Tom Nieman** / Principal, Office Properties / tnieman@picor.com / + 1 520 546 2728

*Independently Owned and Operated / A Member of the Cushman & Wakefield Alliance*  
4/16/2019  
Cushman & Wakefield Copyright 2019. No warranty or representation, express or implied, is made to the accuracy or completeness of the information contained herein, and same is submitted subject to errors, omissions, change of price, rental or other conditions, withdrawal without notice, and to any special listing conditions imposed by the property owner(s). As applicable, we make no representation as to the condition of the property (or properties) in question.



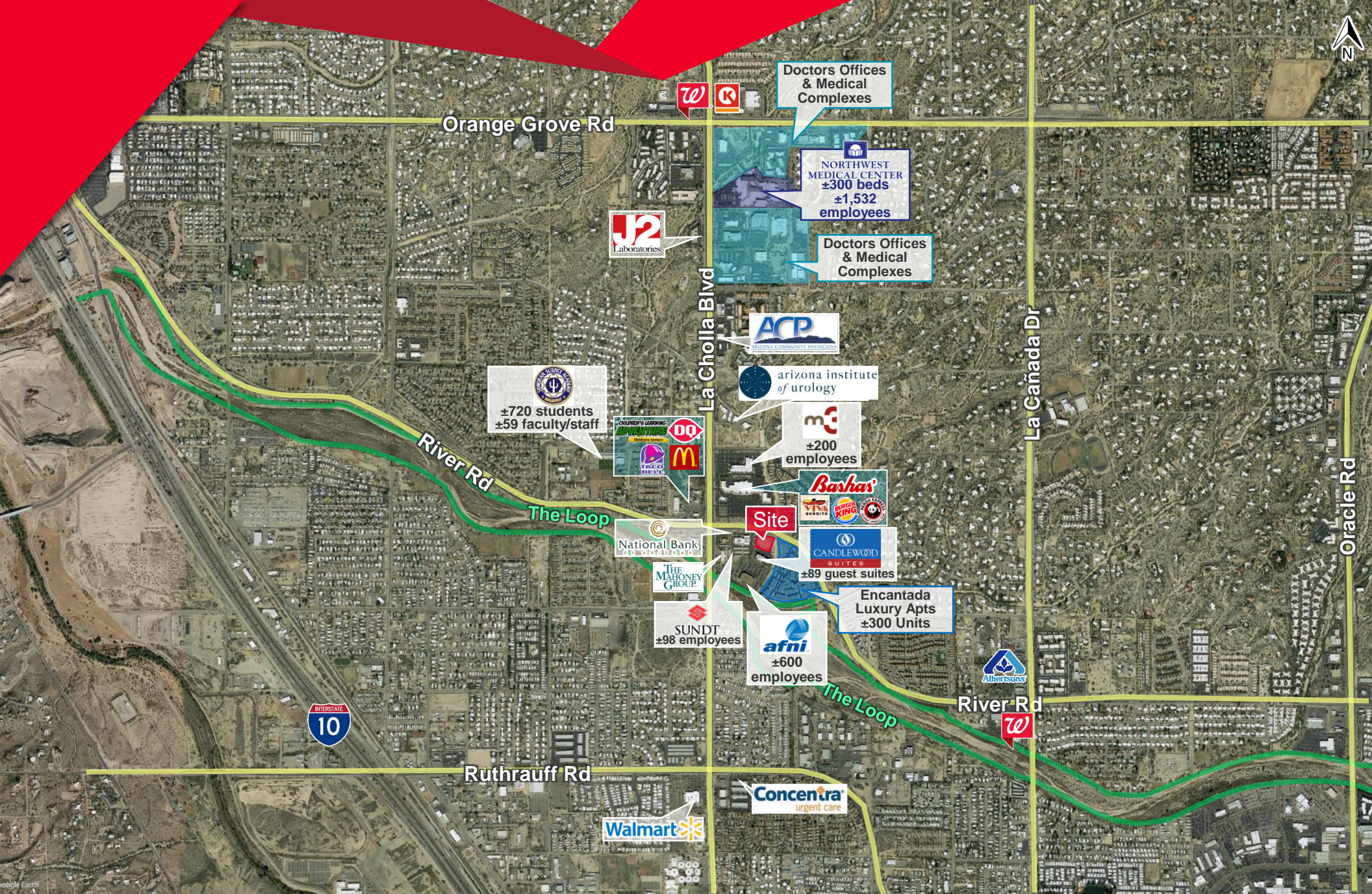

**Dave Hammack** / dhammack@picor.com / +1 520 546 2712  
**Tom Nieman** / tnieman@picor.com / + 1 520 546 2728



**CUSHMAN &  
WAKEFIELD**



**PICOR**

**WE ARE THE CENTER OF RETAIL**

PICOR.COM

A commission computed and earned in accordance with the rates and conditions of our agency agreement with our principal, when received from our principal, will be paid to the cooperating broker who consummates a lease which is unconditionally executed and delivered by and between lessor and lessee (a copy of the rates and conditions referred to above is available upon request). The depiction in the attached images of any person, entity, sign, logo or property (other than Cushman & Wakefield's client and the property offered by Cushman & Wakefield) is incidental only, and is not intended to connote any affiliation, connection, association, sponsorship or approval by or between that which is incidentally depicted by Cushman & Wakefield or its client.

4/16/2019