



**±15,000 SF**

**Lease Rate: \$0.75/SF NNN**

### Property Highlights

- 4 docks and one 12' grade level door
- Can demise space down to ±7,500 SF
- Small fenced yard available for tenant's use
- Conveniently located adjacent to Interstate 10
- Located within the highly sought-after Northwest market

### Property Details

Availability	March 31, 2025
Est. NNN	\$0.30/SF
Building Size	±54,198 SF
HVAC	HVAC in office / Evap in warehouse
Clear / Ceiling Height	16'
Zoning	I-1
Loading	4 docks and one 12' grade level door



**Jesse Blum, SIOR**  
Principal, Industrial Properties  
+1 520 546 2772  
[jblum@picor.com](mailto:jblum@picor.com)

**Alex Demeroutis**  
Industrial Properties  
+1 520 546 2773  
[ademoroutis@picor.com](mailto:ademoroutis@picor.com)

**PICOR Commercial Real Estate Services**  
5151 E. Broadway Blvd, Suite 115  
Tucson, Arizona 85711  
phone: +1 520 748 7100  
[picor.com](http://picor.com)

## Floor Plan

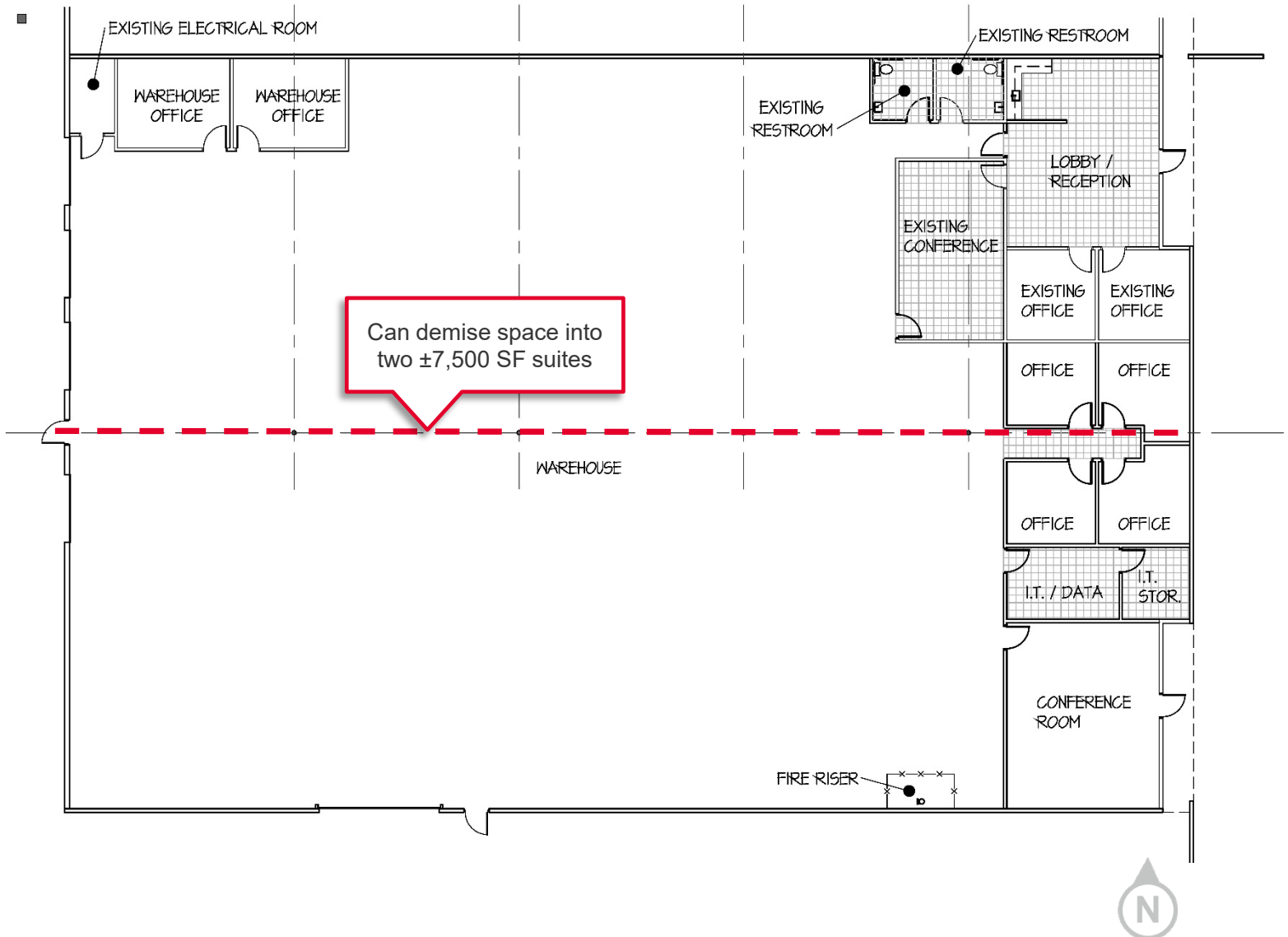

**Jesse Blum, SIOR**  
Principal, Industrial Properties  
+1 520 546 2772  
[jblum@picor.com](mailto:jblum@picor.com)

**Alex Demeroutis**  
Industrial Properties  
+1 520 546 2773  
[ademmeroutis@picor.com](mailto:ademmeroutis@picor.com)

**PICOR Commercial Real Estate Services**  
5151 E. Broadway Blvd, Suite 115  
Tucson, Arizona 85711  
phone: +1 520 748 7100  
[picor.com](http://picor.com)



Aerial Photo



**Jesse Blum, SIOR**  
**Principal, Industrial Properties**  
+1 520 546 2772  
[jblum@picor.com](mailto:jblum@picor.com)

**Alex Demeroutis**  
**Industrial Properties**  
+1 520 546 2773  
[ademmeroutis@picor.com](mailto:ademmeroutis@picor.com)

**PICOR Commercial Real Estate Services**  
5151 E. Broadway Blvd, Suite 115  
Tucson, Arizona 85711  
phone: +1 520 748 7100  
[picor.com](http://picor.com)

*Independently Owned and Operated / A Member of the Cushman & Wakefield Alliance*

Cushman & Wakefield Copyright 2022. No warranty or representation, express or implied, is made to the accuracy or completeness of the information contained herein, and same is submitted subject to errors, omissions, change of price, rental or other conditions, withdrawal without notice, and to any special listing conditions imposed by the property owner(s). As applicable, we make no representation as to the condition of the property (or properties) in question.

2/26/2025

## Trade Map

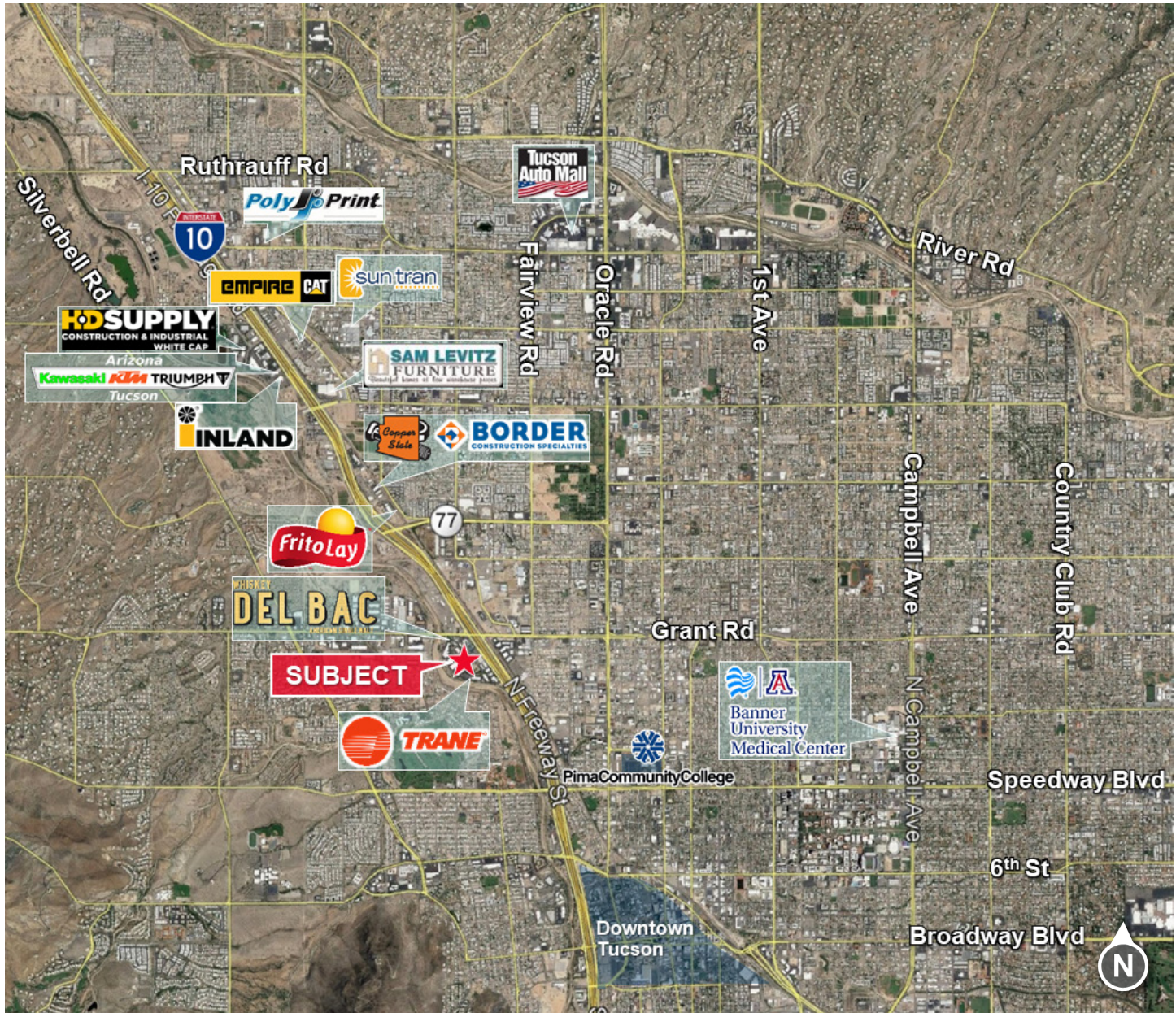

**Jesse Blum, SIOR**  
Principal, Industrial Properties  
+1 520 546 2772  
[jblum@picor.com](mailto:jblum@picor.com)

**Alex Demeroutis**  
Industrial Properties  
+1 520 546 2773  
[ademmeroutis@picor.com](mailto:ademmeroutis@picor.com)

**PICOR Commercial Real Estate Services**  
5151 E. Broadway Blvd, Suite 115  
Tucson, Arizona 85711  
phone: +1 520 748 7100  
[picor.com](http://picor.com)

*Independently Owned and Operated / A Member of the Cushman & Wakefield Alliance*

Cushman & Wakefield Copyright 2022. No warranty or representation, express or implied, is made to the accuracy or completeness of the information contained herein, and same is submitted subject to errors, omissions, change of price, rental or other conditions, withdrawal without notice, and to any special listing conditions imposed by the property owner(s). As applicable, we make no representation as to the condition of the property (or properties) in question.

2/26/2025