

ARIZONA PAVILIONS

Cortaro Road & Arizona Pavilions Drive | Marana, AZ

CUSHMAN &
WAKEFIELD

PICOR

100% LEASED



ARIZONA PAVILIONS

Cortaro Road & Arizona Pavilions Drive | Marana, AZ

CUSHMAN &
WAKEFIELD

PICOR



PROPERTY DETAILS

Availability	100% Leased
Lease Rate	Contact Agent
NNN Rate	Contact Agent
Year Built	2004
Zoning	Continental Ranch Zone F (Specific Plan) Town of Marana

HIGHLIGHTS

- Major retail core for Northwest Tucson
- Freeway location with over 48,500+ VPD
- Monument Signage
- Strong lineup of national tenants including Wal-Mart, Kohls, TJ Maxx, Dollar Tree, Home Goods, Chipotle, Verizon, Starbucks, Petco, and many more

TRAFFIC COUNTS

I-10	104,575 VPD (2023)
Cortaro Rd	30,186 VPD (2023)
Arizona Pavilions Dr	19,080 VPD (2023)

DEMOGRAPHICS

	Population	Average Household Income	Daytime Population
1 Mile	11,349	\$102,897	4,097
3 Miles	286,848	\$87,145	107,617
5 Miles	564,215	\$78,198	250,698

Dave Hammack / Principal / dhammack@picor.com / +1 520 546 2712
Aaron LaPrise / Principal / alaprise@picor.com / +1 520 546 2770

Independently Owned and Operated / A Member of the Cushman & Wakefield Alliance
8/7/2024

Cushman & Wakefield Copyright 2022. No warranty or representation, express or implied, is made to the accuracy or completeness of the information contained herein, and same is submitted subject to errors, omissions, change of price, rental or other conditions, withdrawal without notice, and to any special listing conditions imposed by the property owner(s). As applicable, we make no representation as to the condition of the property (or properties) in question.

ARIZONA PAVILIONS

Cortaro Road & Arizona Pavilions Drive | Marana, AZ

CUSHMAN & WAKEFIELD

PICOR

SITE PLAN

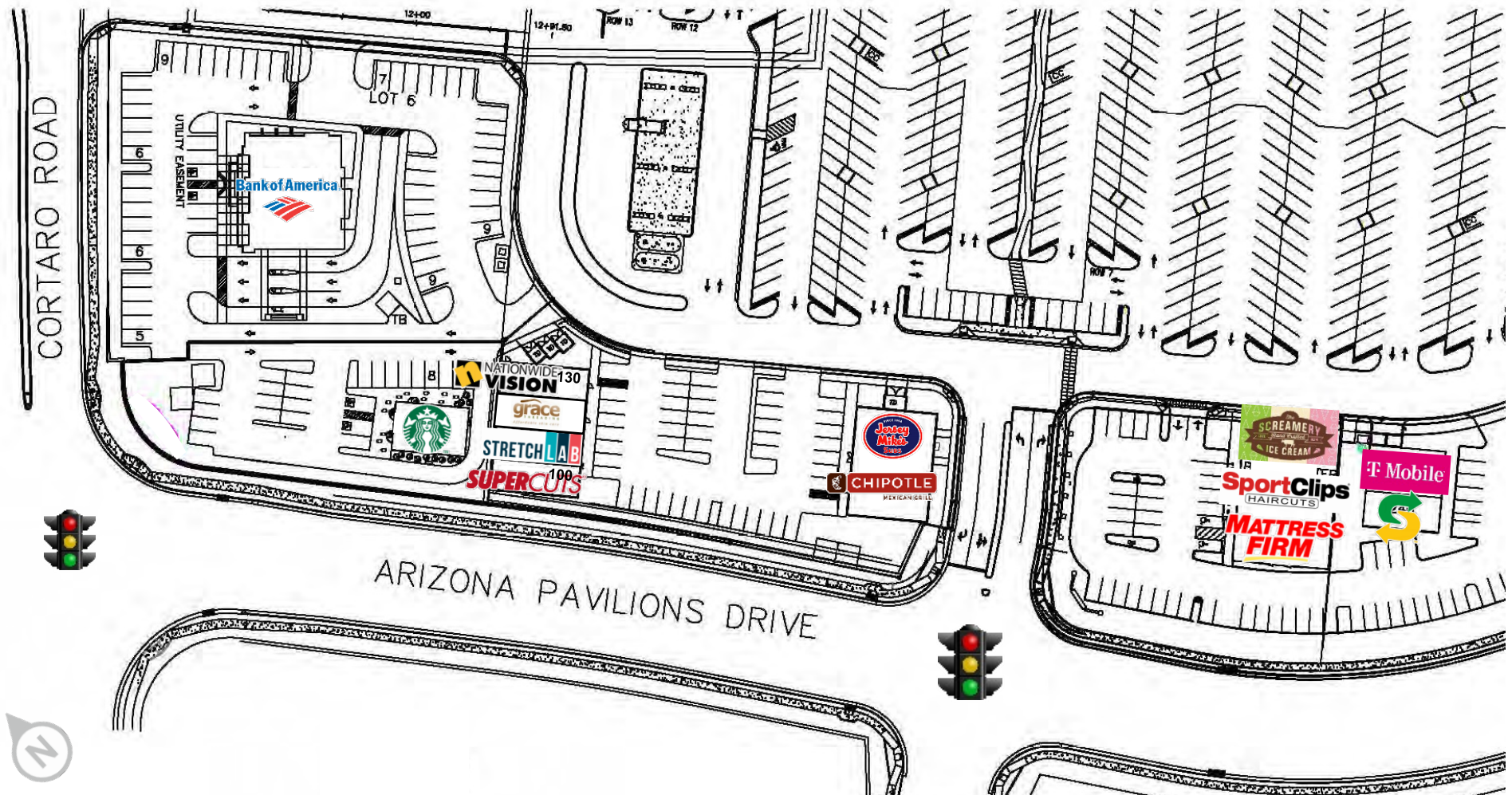

Dave Hammack / Principal / dhammack@picor.com / +1 520 546 2712
Aaron LaPrise / Principal / alaprise@picor.com / +1 520 546 2770

Independently Owned and Operated / A Member of the Cushman & Wakefield Alliance
8/7/2024

Cushman & Wakefield Copyright 2022. No warranty or representation, express or implied, is made to the accuracy or completeness of the information contained herein, and same is submitted subject to errors, omissions, change of price, rental or other conditions, withdrawal without notice, and to any special listing conditions imposed by the property owner(s). As applicable, we make no representation as to the condition of the property (or properties) in question.

ARIZONA PAVILIONS

Cortaro Road & Arizona Pavilions Drive | Marana, AZ

CUSHMAN &
WAKEFIELD

PICOR



Dave Hammack / Principal / dhammack@picor.com / +1 520 546 2712
Aaron LaPrise / Principal / alaprise@picor.com / +1 520 546 2770

Independently Owned and Operated / A Member of the Cushman & Wakefield Alliance
8/7/2024

Cushman & Wakefield Copyright 2022. No warranty or representation, express or implied, is made to the accuracy or completeness of the information contained herein, and same is submitted subject to errors, omissions, change of price, rental or other conditions, withdrawal without notice, and to any special listing conditions imposed by the property owner(s). As applicable, we make no representation as to the condition of the property (or properties) in question.

ARIZONA PAVILIONS

Cortaro Road & Arizona Pavilions Drive | Marana, AZ

CUSHMAN &
WAKEFIELD

PICOR



Dave Hammack / Principal / dhammack@picor.com / +1 520 546 2712
Aaron LaPrise / Principal / alaprise@picor.com / +1 520 546 2770

Independently Owned and Operated / A Member of the Cushman & Wakefield Alliance
8/7/2024

Cushman & Wakefield Copyright 2022. No warranty or representation, express or implied, is made to the accuracy or completeness of the information contained herein, and same is submitted subject to errors, omissions, change of price, rental or other conditions, withdrawal without notice, and to any special listing conditions imposed by the property owner(s). As applicable, we make no representation as to the condition of the property (or properties) in question.

ARIZONA PAVILIONS

Cortaro Road & Arizona Pavilions Drive | Marana, AZ

CUSHMAN &
WAKEFIELD

PICOR

