



## 800 SF Office/ Industrial Yard Available

**Sale Price: \$225,000**

### Property Highlights

- 800 SF office
- 400 SF storage shed
- 300 SF covered storage
- Fenced yard
- MU Zoning
- 10,182 SF lot

### Property Details

|            |  |
|------------|--|
| Available  | 800 SF Office<br>400 SF Storage shed<br>300 SF Covered storage |
| Sale Price | \$225,000  |
| Lot Size   | 10,182 SF lot  |
| Zoning     | MU   |



For more information, please contact:

**Molly Mary Gilbert**  
**Office Properties**  
+1 520 546 2766  
[mgilbert@picor.com](mailto:mgilbert@picor.com)

**PICOR Commercial Real Estate Services**  
5151 E. Broadway Blvd, Suite 115  
Tucson, Arizona 85711  
phone: +1 520 748 7100  
[picor.com](http://picor.com)



## Property Photos



Yard



Yard



Office



Office

*Independently Owned and Operated / A Member of the Cushman & Wakefield Alliance*

Cushman & Wakefield Copyright 2020. No warranty or representation, express or implied, is made to the accuracy or completeness of the information contained herein, and same is submitted subject to errors, omissions, change of price, rental or other conditions, withdrawal without notice, and to any special listing conditions imposed by the property owner(s). As applicable, we make no representation as to the condition of the property (or properties) in question.

2/8/2021



**Aerial**

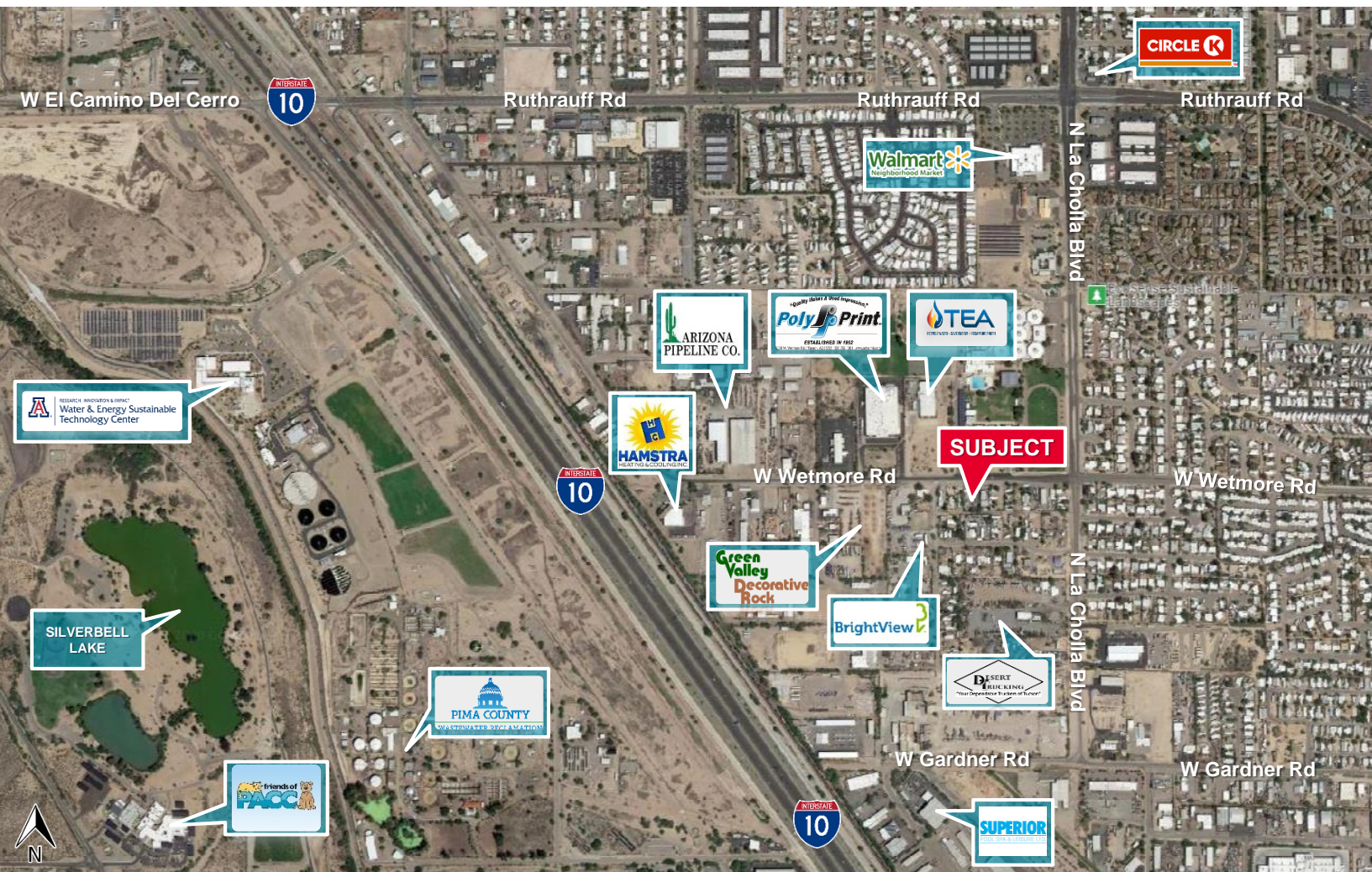

**Molly Mary Gilbert**  
**Office Properties**  
+1 520 546 2766  
mgilbert@picor.com

**PICOR Commercial Real Estate Services**  
5151 E. Broadway Blvd, Suite 115  
Tucson, Arizona 85711  
phone: +1 520 748 7100  
picor.com

*Independently Owned and Operated / A Member of the Cushman & Wakefield Alliance*

Cushman & Wakefield Copyright 2020. No warranty or representation, express or implied, is made to the accuracy or completeness of the information contained herein, and same is submitted subject to errors, omissions, change of price, rental or other conditions, withdrawal without notice, and to any special listing conditions imposed by the property owner(s). As applicable, we make no representation as to the condition of the property (or properties) in question.

2/8/2021