



FOR LEASE – NEW INDUSTRIAL BUILDINGS

Old Vail Commerce Center

Tucson, Arizona 85747



Stephen D. Cohen
Principal, Industrial Properties
+1 520 546 2750
scohen@picor.com

PICOR Commercial Real Estate Services
5151 E. Broadway Blvd, Suite 115
Tucson, Arizona 85711
phone: +1 520 748 7100
picor.com

Independently Owned and Operated / A Member of the Cushman & Wakefield Alliance

Cushman & Wakefield Copyright 2022. No warranty or representation, express or implied, is made to the accuracy or completeness of the information contained herein, and same is submitted subject to errors, omissions, change of price, rental or other conditions, withdrawal without notice, and to any special listing conditions imposed by the property owner(s). As applicable, we make no representation as to the condition of the property (or properties) in question.

6/1/2023



1,270,000 SF of New Warehouse Space

Property Highlights

- Phased project
- Q1 2025 Delivery
- Located in Rita Ranch, a 3,300-acre mixed use project with a residential population of 14,645
- Developed by Buzz Oates, one of the largest privately held commercial real estate investment management companies in the country
- Near the University of Arizona Tech Park Arizona
- Close to Rita Road and Kolb Road interchanges with Interstate 10
- Accessible to the area's largest labor force on the East Side of Tucson

Property Details

Acres	95.78
Clear Height	32'
Sprinkler	ESFR
Construction	Concrete Tilt-Up
Delivery Date	Q1 2025

Site Plan

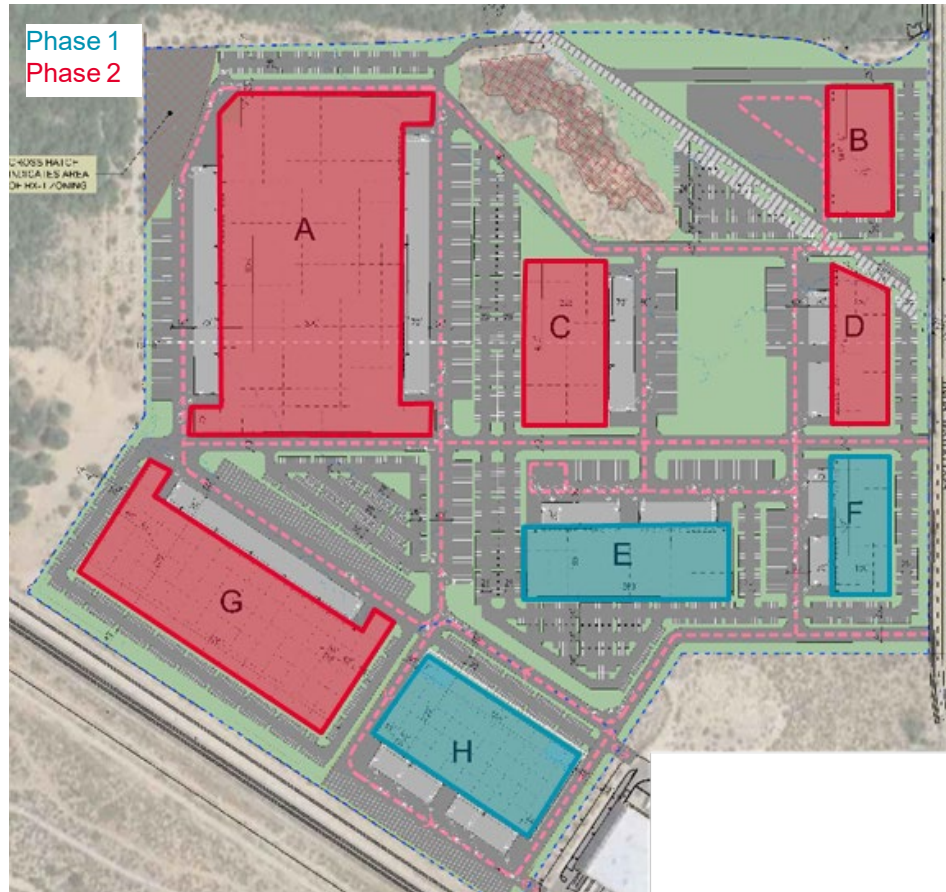

Bldg.	Building SF	Site SF	Parking	Ratio / 1,000	Dock Stalls	Grade Level O.H.	Trailer Parking
A	464,500	31.99	501	1.08	80	4	99
B	58,820	8.05	86	1.46	To Suit	6	To Suit
C	101,250	10.19	175	1.73	24	2	30
D	87,983	6.13	55	0.63	20	2	31
E	103,600	13.21	320	3.09	28	2	79
F	55,800	5.22	122	2.19	18	2	19
G	267,600	12.89	140	0.52	39	2	69
H	131,040	8.26	194	1.48	28	4	46
TOTAL	1,270,593	95.94	1,593	1.25	237	24	373

Phase 1: Buildings E, F, and H

Stephen D. Cohen
Principal, Industrial Properties
 +1 520 546 2750
scohen@picor.com

PICOR Commercial Real Estate Services
 5151 E. Broadway Blvd, Suite 115
 Tucson, Arizona 85711
 phone: +1 520 748 7100
picor.com

Architectural Rendering

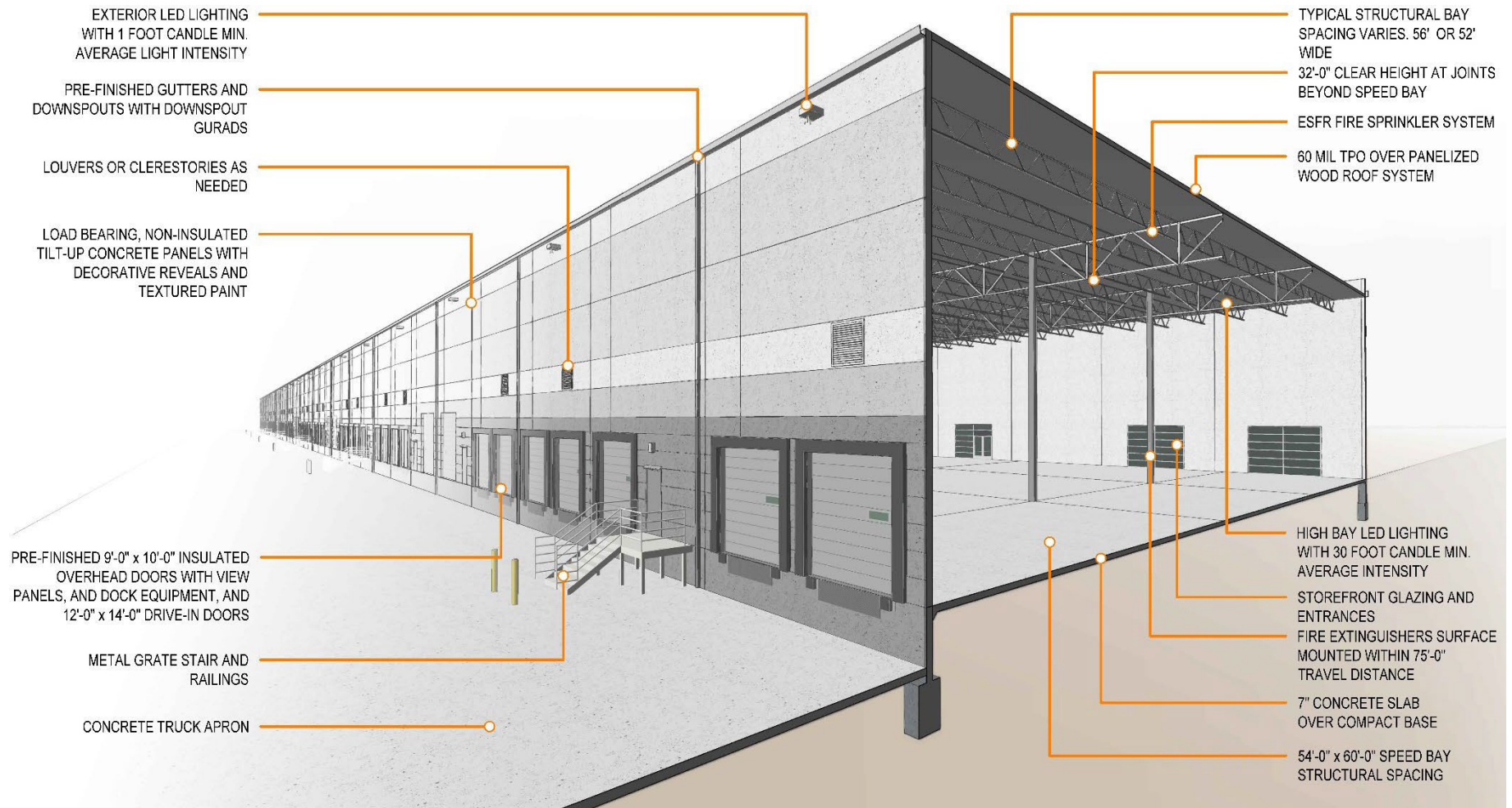

Stephen D. Cohen
Principal, Industrial Properties
 +1 520 546 2750
scohen@picor.com

PICOR Commercial Real Estate Services
 5151 E. Broadway Blvd, Suite 115
 Tucson, Arizona 85711
 phone: +1 520 748 7100
picor.com

Independently Owned and Operated / A Member of the Cushman & Wakefield Alliance

Cushman & Wakefield Copyright 2022. No warranty or representation, express or implied, is made to the accuracy or completeness of the information contained herein, and same is submitted subject to errors, omissions, change of price, rental or other conditions, withdrawal without notice, and to any special listing conditions imposed by the property owner(s). As applicable, we make no representation as to the condition of the property (or properties) in question.

Employment Map



Independently Owned and Operated / A member of the Cushman & Wakefield Alliance
 Cushman & Wakefield Copyright 2022. No warranty or representation, express or implied, is made to the accuracy or completeness of the information contained herein, and same is submitted subject to errors, omissions, change of price, rental or other conditions, withdrawal without notice, and to any special listing conditions imposed by the property owner(s). As applicable, we make no representation as to the condition of the property (or properties) in question.



1.058M
TUCSON MSA
POPULATION



434,692
TOTAL HOUSEHOLDS



25%
EDUCATION-
SOME COLLEGE



1.0%
POPULATION
GROWTH RATE



\$59,391
MEDIAN HOUSEHOLD
INCOME



3.3%
UNEMPLOYMENT
RATE

Source: BLS, BOC, Moody's Analytics 11/28/22

LARGEST EMPLOYERS

1. UNIVERSITY OF ARIZONA- 15,907
 2. RAYTHEON MISSILE SYSTEMS- 13,000
 3. DAVIS-MONTHAN AFB- 11,769
 4. STATE OF ARIZONA – 8,580
- www.arizona.edu, suncorridorinc.com

RECENT INDUSTRY ARRIVALS & EXPANSIONS

1. AMAZON
2. CATERPILLAR SURFACE MINING & TECHNOLOGY
3. HEXAGON MINING
4. BECTON DICKINSON
5. TUSIMPLE



46,932
UNIVERSITY OF ARIZONA
TOTAL ENROLLMENT, 2022

- #5 MANAGEMENT INFORMATION SYSTEMS
- #10 SPACE SCIENCE
- #29 NURSING
- #48 TOP PUBLIC SCHOOL
- #54 UNDERGRAD ENGINEERING PROGRAMS
- #67 COLLEGES FOR VETERANS
- #47 BEST BUSINESS SCHOOLS
- #108 BEST GLOBAL UNIVERSITY

UNIVERSITY OF ARIZONA TOP PROGRAMS
U.S. News & World Report