

**PROFESSIONAL MEDICAL
OFFICE CAMPUS**

Professional Medical Office Campus

\$25.00 per RSF, NNN

Includes \$60.00 per RSF Tenant Improvement Allowance

Property Highlights

- Exceptional location adjacent to Tucson Mall and next door to Chuze Fitness
- Building Remodel/Renovation Underway
- Common Lobby, Restrooms Conference Room
- Excellent access from Oracle Road and/or Auto Mall Drive
- Great visibility from road
- Close to all amenities

Property Details

Available	Up to 6,891 RSF
Possession	Upon Completion of Tenant Improvements
Parking	Excellent – Drive Up

Thomas J. Nieman
Principal, Office Properties
+1 520 546 2728
tnieman@picor.com

PICOR Commercial Real Estate Services
5151 E. Broadway Blvd, Suite 115
Tucson, Arizona 85711
phone: +1 520 748 7100
picor.com

Aerial



Thomas J. Nieman
Principal, Office Properties
+1 520 546 2728
tنيان@picor.com

Independently Owned and Operated / A Member of the Cushman & Wakefield Alliance

Cushman & Wakefield Copyright 2022. No warranty or representation, express or implied, is made to the accuracy or completeness of the information contained herein, and same is submitted subject to errors, omissions, change of price, rental or other conditions, withdrawal without notice, and to any special listing conditions imposed by the property owner(s). As applicable, we make no representation as to the condition of the property (or properties) in question.

8/31/2023

Floor Plan

Suite 3 – Approximately 3,445 RSF

Suite 4 – Approximately 3,446 RSF

- Spaces may be reconfigured as required

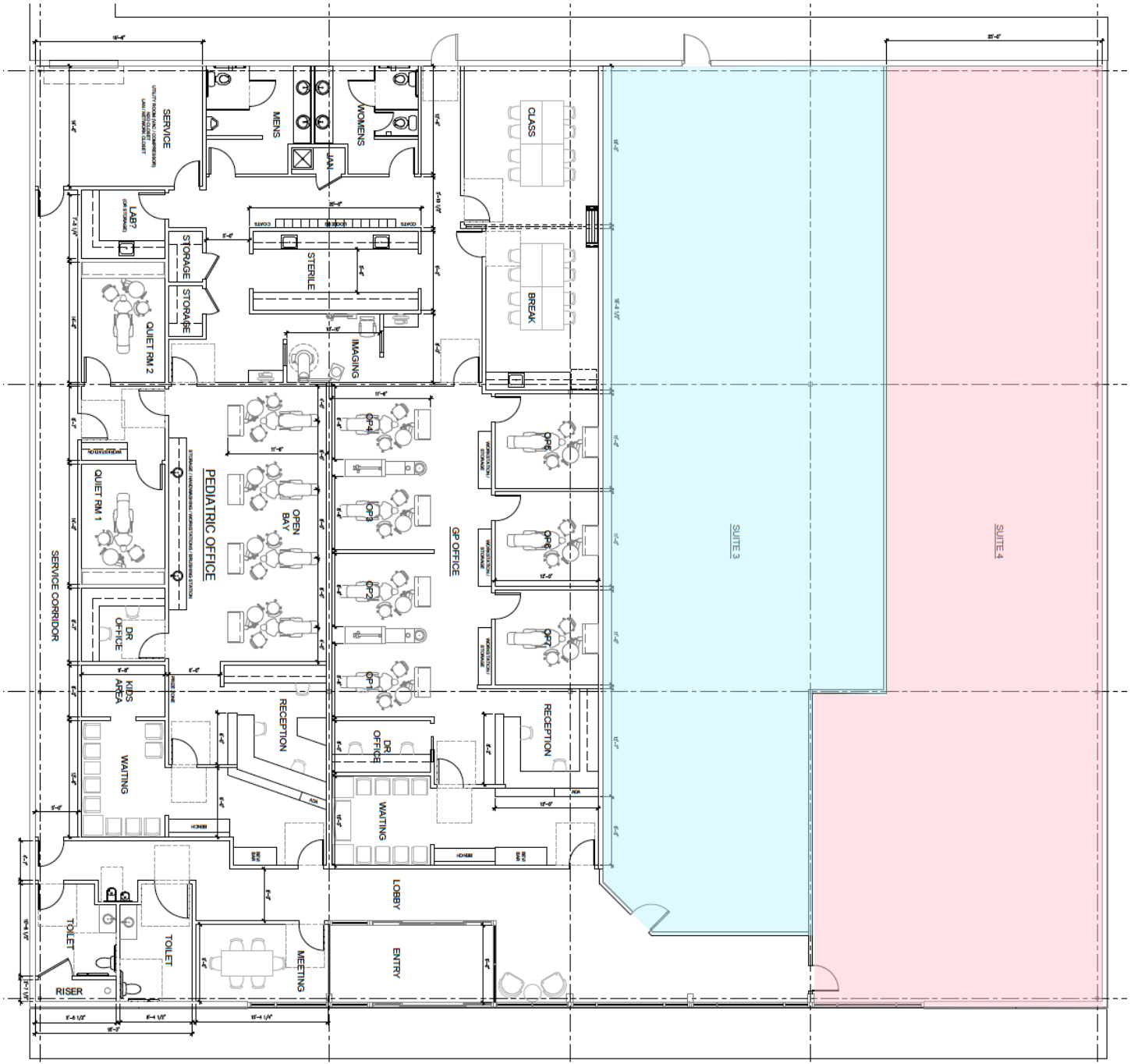

Trade Map

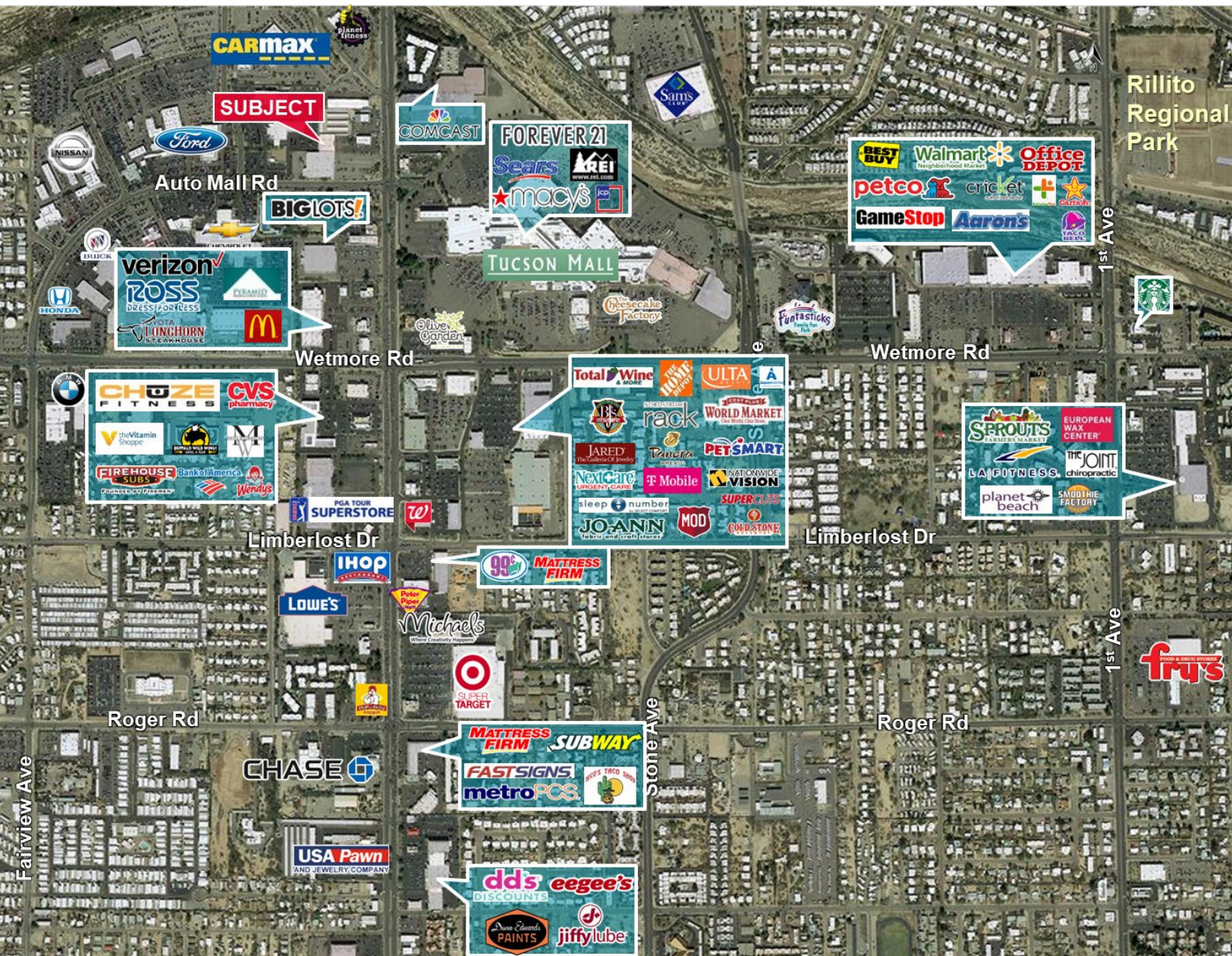

Thomas J. Nieman
Principal, Office Properties
+1 520 546 2728
tnieman@picor.com

Independently Owned and Operated / A Member of the Cushman & Wakefield Alliance

Cushman & Wakefield Copyright 2022. No warranty or representation, express or implied, is made to the accuracy or completeness of the information contained herein, and same is submitted subject to errors, omissions, change of price, rental or other conditions, withdrawal without notice, and to any special listing conditions imposed by the property owner(s). As applicable, we make no representation as to the condition of the property (or properties) in question.

8/31/2023