



## 7,000-37,100± Square Feet

### Property Highlights

- Located in the Tucson International Business Center, a master planned industrial park
- Near Tucson International Airport
- Easy access to I-10 and I-19 via Valencia and Palo Verde Roads
- Highly improved space
- 13 - Class 100000 (Class 10000 capable) clean rooms
- High tech manufacturing and laboratory
- Engineering, clerical, managerial and conference spaces
- 2 walk in freezers
- Ideal for R&D/lab space
- Server room with temperature and dry fire suppression system
- Divisible

### Property Details

Ceiling Height	20'
Loading	Grade Level
Power	277/480 Volt, 3 Phase
HVAC	100% AC
Sprinkler	Ordinary Hazard
Construction	Concrete Tilt - Up
Year Built	2006 – Improved in 2016
Parking	240 Shared Spaces For Entire Project

**Stephen D. Cohen**  
Principal, Industrial Properties  
+1 520 546 2750  
[scohen@picor.com](mailto:scohen@picor.com)

**PICOR Commercial Real Estate Services**  
5151 E. Broadway Blvd, Suite 115  
Tucson, Arizona 85711  
phone: +1 520 748 7100  
[picor.com](http://picor.com)

*Independently Owned and Operated / A Member of the Cushman & Wakefield Alliance*

Cushman & Wakefield Copyright 2022. No warranty or representation, express or implied, is made to the accuracy or completeness of the information contained herein, and same is submitted subject to errors, omissions, change of price, rental or other conditions, withdrawal without notice, and to any special listing conditions imposed by the property owner(s). As applicable, we make no representation as to the condition of the property (or properties) in question.

7/31/2023

## Floor Plan

Suite	Size	Price / SF	Loading	Min. Term
100	17,500	95¢ / SF	3 OH Doors	5 years
200	7,000	95¢ / SF	2 OH Doors	5 years
300	12,600	90¢ / SF	2 OH Doors	5 years
<b>Total</b>	<b>37,100</b>	<b>89¢ / SF</b>	<b>7 OH Doors</b>	<b>5 years</b>

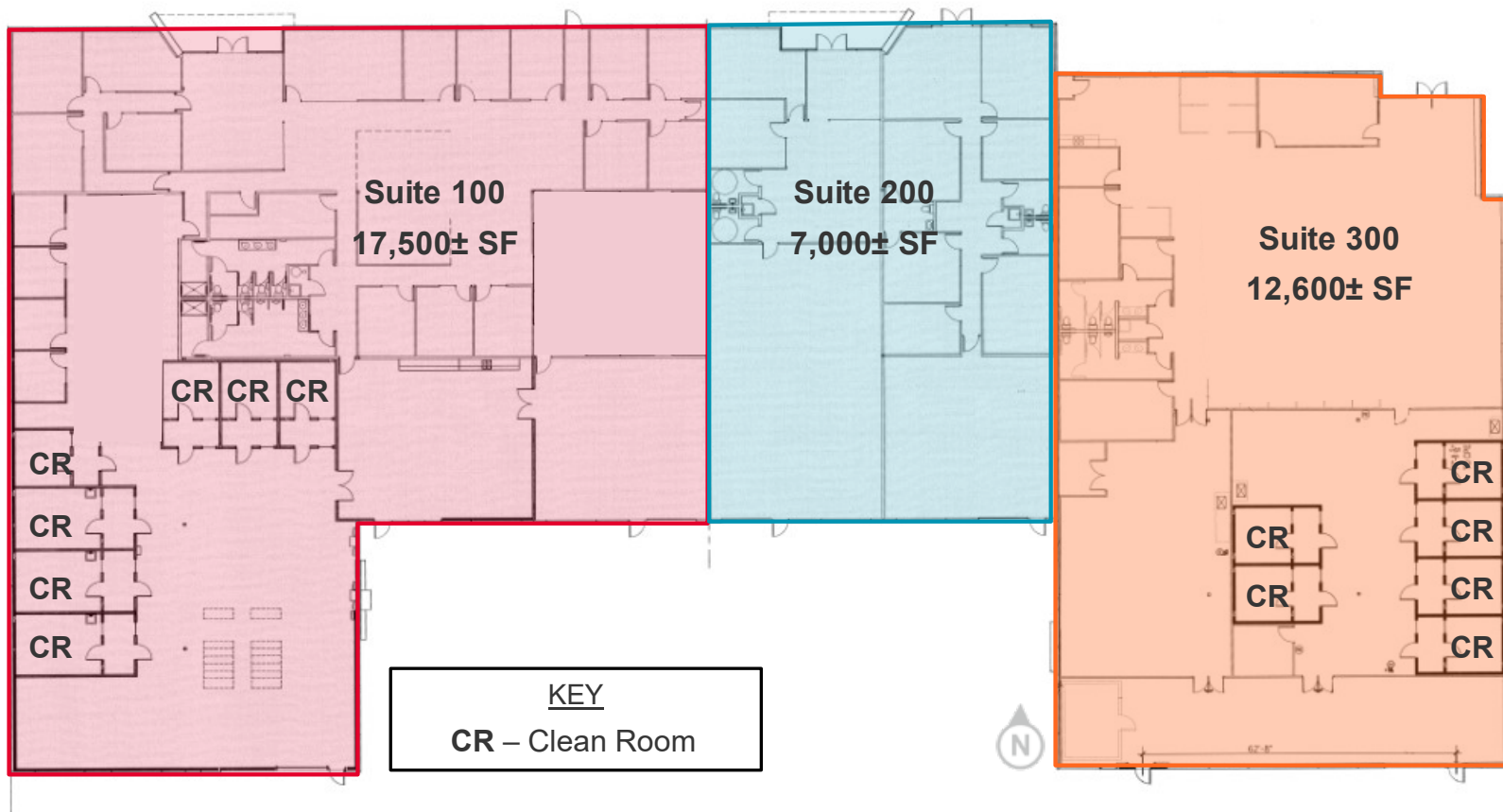

Site Plan

Aerial

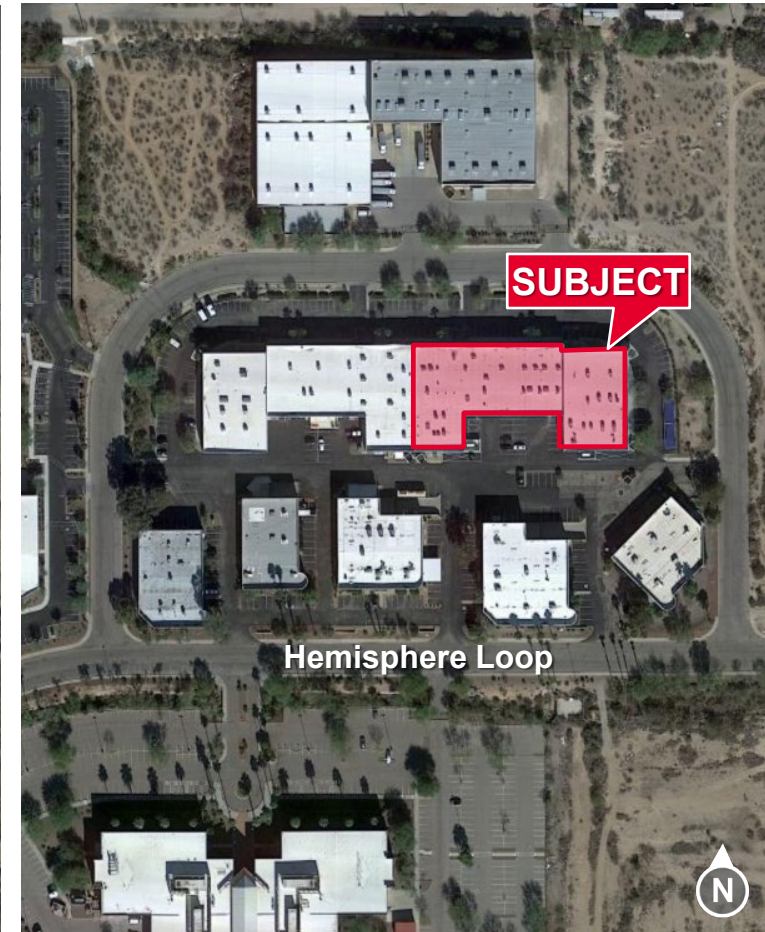

Employment Map



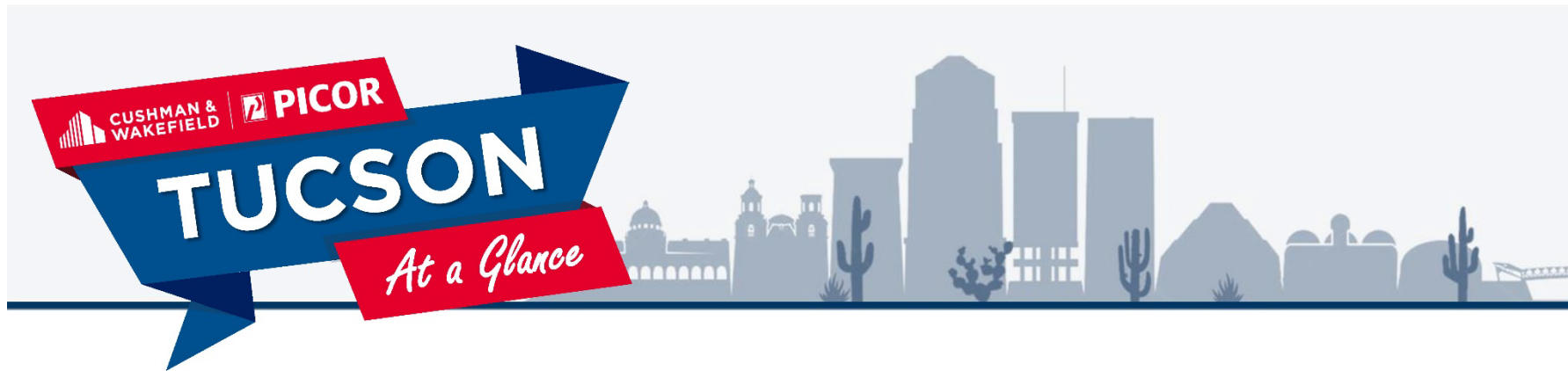

**1.072M**  
TUCSON MSA  
POPULATION



**437,780**  
TOTAL HOUSEHOLDS



**34.8%**  
EDUCATION-  
SOME COLLEGE



**1.3%**  
POPULATION  
GROWTH RATE



**\$59,215**  
MEDIAN HOUSEHOLD  
INCOME



**3.9%**  
UNEMPLOYMENT  
RATE

Source: arizona.edu, BLS, ACS 06/07/23

## LARGEST EMPLOYERS

1. UNIVERSITY OF ARIZONA- 15,907
2. RAYTHEON MISSILE SYSTEMS- 13,000
3. DAVIS-MONTHAN AFB- 11,769
4. STATE OF ARIZONA - 8,580

[www.arizona.edu](http://www.arizona.edu), [suncorridorinc.com](http://suncorridorinc.com)

## RECENT INDUSTRY ARRIVALS & EXPANSIONS

1. AMAZON
2. CATERPILLAR SURFACE MINING & TECHNOLOGY
3. HEXAGON MINING
4. BECTON DICKINSON
5. TUSIMPLE



**46,932**

UNIVERSITY OF ARIZONA  
TOTAL ENROLLMENT, 2023

- #3 MANAGEMENT INFORMATION SYSTEMS
- #10 SPACE SCIENCE
- #17 MEDICINE
- #18 EDUCATION
- #48 TOP PUBLIC SCHOOL
- #54 UNDERGRAD ENGINEERING PROGRAMS
- #67 COLLEGES FOR VETERANS
- #47 BEST BUSINESS SCHOOLS
- #99 BEST GLOBAL UNIVERSITY

UNIVERSITY OF ARIZONA TOP PROGRAMS  
U.S. News & World Report