

6320-6330 E. GOLF LINKS ROAD

SEC Golf Links & Wilmot | Tucson, AZ

**CUSHMAN &
WAKEFIELD**

PICOR

FOR LEASE



6320-6330 E. GOLF LINKS ROAD

SEC Golf Links & Wilmot | Tucson, AZ



PROPERTY DETAILS

Availability	2 Suites, 1,200 ± SF
Lease Rate	Contact Agent
NNN Rate	\$7.33/SF
Availability	Immediate
Year Built	2001
Zoning	C-I, City of Tucson
Address	6320-6330 E. Golf Links Rd Tucson AZ 85730

HIGHLIGHTS

- Immediately east of Davis-Monthan Air Force Base, which has approximately 9,100 military and civilian employees and is the third-largest employer in Southern Arizona
- High density area with heavy traffic
- Significant tenant improvement allowance available to qualified tenants

TRAFFIC COUNTS

Golf Links Rd	33,331 VPD (2023)
Wilmot Rd	15,388 VPD (2023)

DEMOGRAPHICS	Population	Average Household Income	Daytime Population
1 Mile	17,457	\$59,852	1,995
3 Miles	90,570	\$57,392	38,741
5 Miles	235,479	\$63,875	107,805

Natalie Furrier / nfurrier@picor.com / +1 520 955 7663
Greg Furrier / Principal / gfurrier@picor.com / +1 520 909 6111

Independently Owned and Operated / A Member of the Cushman & Wakefield Alliance
6/13/2024

Cushman & Wakefield Copyright 2022. No warranty or representation, express or implied, is made to the accuracy or completeness of the information contained herein, and same is submitted subject to errors, omissions, change of price, rental or other conditions, withdrawal without notice, and to any special listing conditions imposed by the property owner(s). As applicable, we make no representation as to the condition of the property (or properties) in question.

6320-6330 E. GOLF LINKS ROAD

SEC Golf Links & Wilmot | Tucson, AZ

SITE PLAN

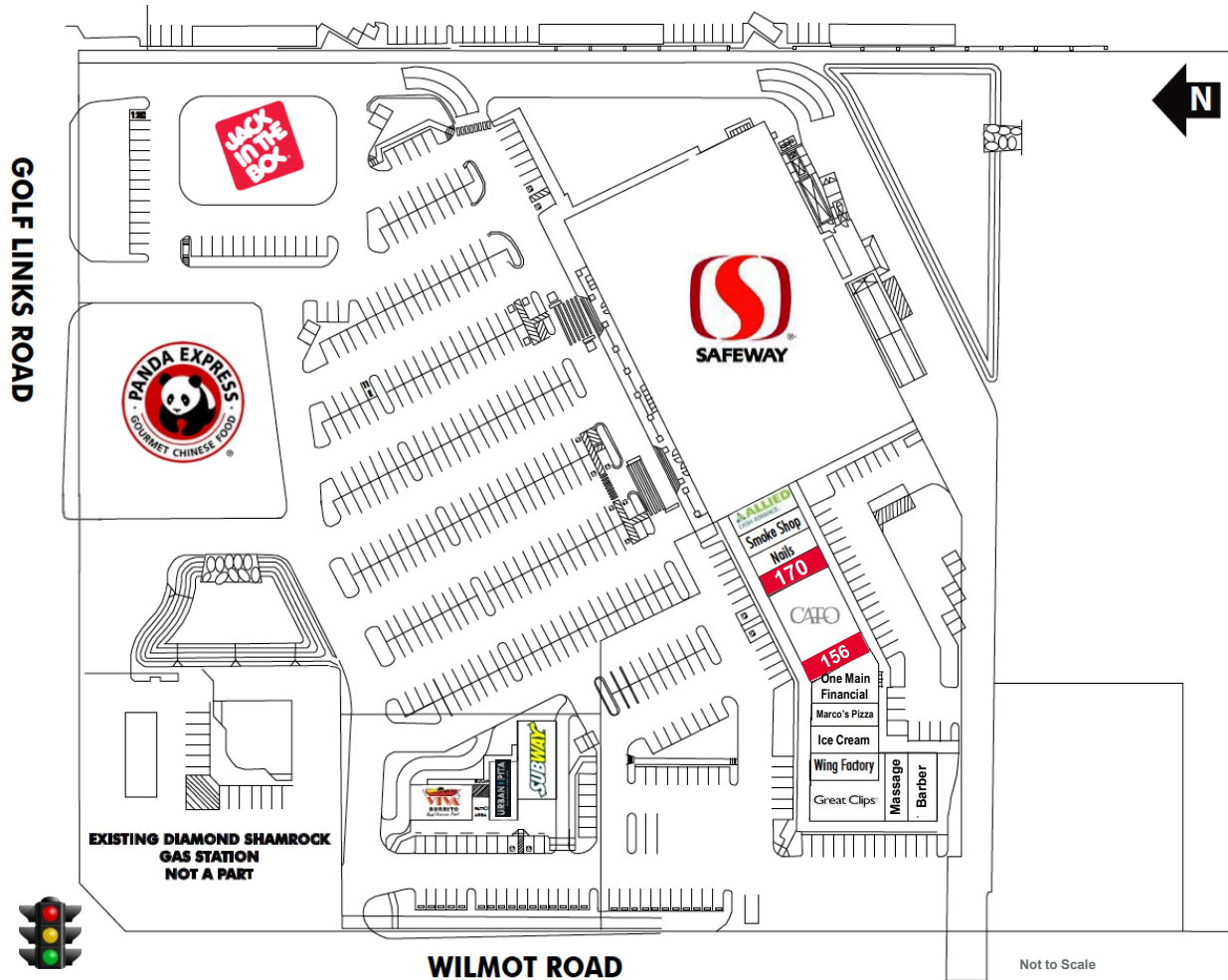

[CLICK TO VIEW VIRTUAL TOUR](#)

Suite Available	Size (SF)
#156	1,200±
#170	1,200±

Natalie Furrier / nfurrier@picor.com / +1 520 955 7663
Greg Furrier / Principal / gfurrier@picor.com / +1 520 909 6111

Independently Owned and Operated / A Member of the Cushman & Wakefield Alliance
6/13/2024

Cushman & Wakefield Copyright 2022. No warranty or representation, express or implied, is made to the accuracy or completeness of the information contained herein, and same is submitted subject to errors, omissions, change of price, rental or other conditions, withdrawal without notice, and to any special listing conditions imposed by the property owner(s). As applicable, we make no representation as to the condition of the property (or properties) in question.

6320-6330 E. GOLF LINKS ROAD

SEC Golf Links & Wilmot | Tucson, AZ

SITE PLAN

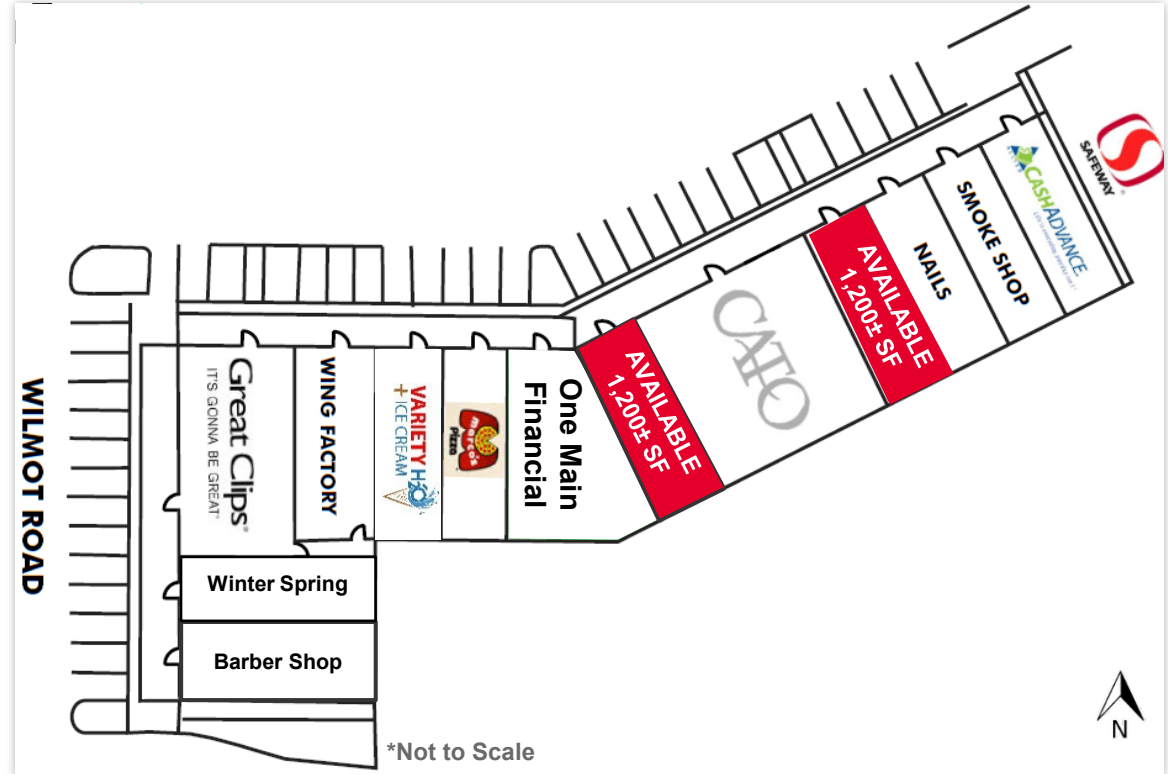
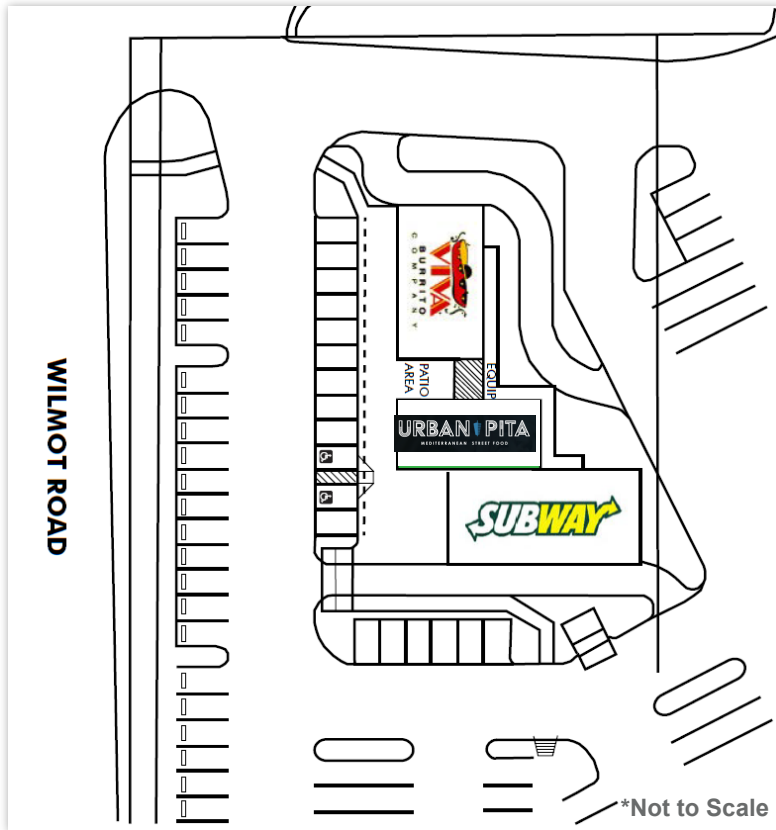

Natalie Furrier / nfurrier@picor.com / +1 520 955 7663
Greg Furrier / Principal / gfurrier@picor.com / +1 520 909 6111

Independently Owned and Operated / A Member of the Cushman & Wakefield Alliance
6/13/2024

Cushman & Wakefield Copyright 2022. No warranty or representation, express or implied, is made to the accuracy or completeness of the information contained herein, and same is submitted subject to errors, omissions, change of price, rental or other conditions, withdrawal without notice, and to any special listing conditions imposed by the property owner(s). As applicable, we make no representation as to the condition of the property (or properties) in question.

FLOOR PLAN – SUITE 156



Natalie Furrier / nfurrier@picor.com / +1 520 955 7663
Greg Furrier / Principal / gfurrier@picor.com / +1 520 909 6111

Independently Owned and Operated / A Member of the Cushman & Wakefield Alliance
6/13/2024

Cushman & Wakefield Copyright 2022. No warranty or representation, express or implied, is made to the accuracy or completeness of the information contained herein, and same is submitted subject to errors, omissions, change of price, rental or other conditions, withdrawal without notice, and to any special listing conditions imposed by the property owner(s). As applicable, we make no representation as to the condition of the property (or properties) in question.

6320-6330 E. GOLF LINKS ROAD

SEC Golf Links & Wilmot | Tucson, AZ

CUSHMAN & WAKEFIELD

PICOR

FLOOR PLAN – SUITE 170

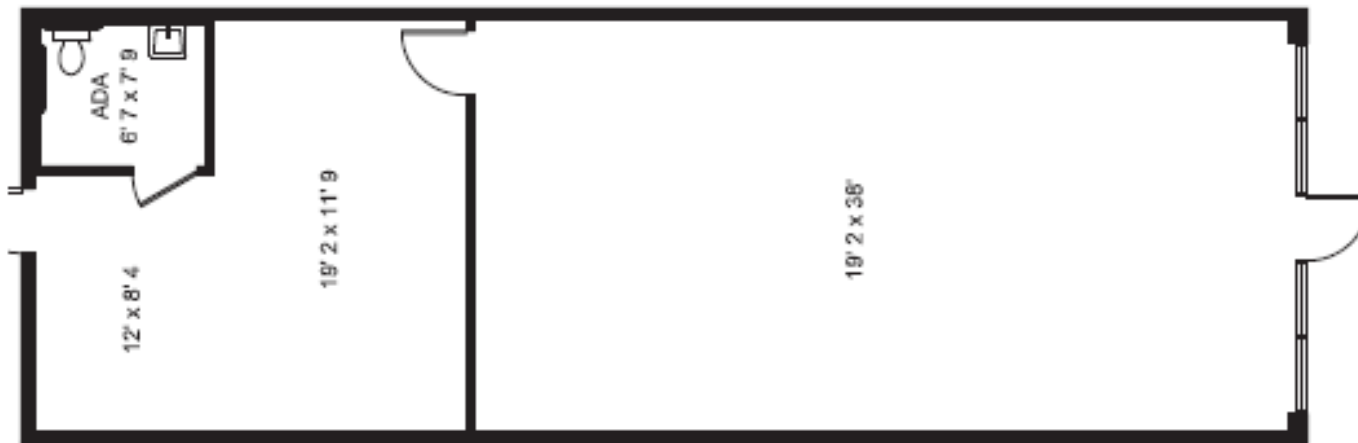

Natalie Furrier / nfurrier@picor.com / +1 520 955 7663
Greg Furrier / Principal / gfurrier@picor.com / +1 520 909 6111

Independently Owned and Operated / A Member of the Cushman & Wakefield Alliance
6/13/2024

Cushman & Wakefield Copyright 2022. No warranty or representation, express or implied, is made to the accuracy or completeness of the information contained herein, and same is submitted subject to errors, omissions, change of price, rental or other conditions, withdrawal without notice, and to any special listing conditions imposed by the property owner(s). As applicable, we make no representation as to the condition of the property (or properties) in question.



Golf Links Rd

33,331 VPD (2023)



Wilmot Rd 15,388 VPD (2023)



SAFEBWAY

1,200± SF
1,200± SF
1,200± SF
AVAILABLE
AVAILABLE
AVAILABLE

BURRITO
URBAN PITA
SUBWAY



Great Clips
Wing Factory
Winter Spring Barber Shop

Natalie Furrier / nfurrier@picor.com / +1 520 955 7663
Greg Furrier / Principal / gfurrier@picor.com / +1 520 909 6111

Independently Owned and Operated / A Member of the Cushman & Wakefield Alliance
6/13/2024

Cushman & Wakefield Copyright 2022. No warranty or representation, express or implied, is made to the accuracy or completeness of the information contained herein, and same is submitted subject to errors, omissions, change of price, rental or other conditions, withdrawal without notice, and to any special listing conditions imposed by the property owner(s). As applicable, we make no representation as to the condition of the property (or properties) in question.